

**FOREST COUNTY FORESTRY DEPARTMENT
200 EAST MADISON STREET
CRANDON, WI 54520
715/478-3475**

TO: PROSPECTIVE BIDDERS OF FOREST COUNTY TIMBER SALES

SUBJECT: 2014 ANNUAL TIMBER SALE OFFERINGS

BID DEADLINE: MAY 5, 2014 4:00 PM

PLACE: COUNTY BOARD ROOM, COURTHOUSE - CRANDON, WISCONSIN

Enclosed are timber sale maps of this year's sales, with a timber sale bid form listing the minimum bids for each timber sale.

I am including one timber sale bid form with each timber sale map. Separate bid forms are necessary for each timber sale. Please compare the tract number at the top of each map with the tract number at the top of the timber sale bid form to be sure you are bidding on the correct timber sale. The bid must meet or exceed the total timber sale value that was advertised.

Please list the tract number of the sale on your envelope when submitting bids. All timber sale contracts will be two years in length. The Forestry Committee may grant a one-year contract extension with a 10% stumpage price increase with prior approval. No contract will exceed four years in length. **Bid bonds will be waived for 2014.** Failure to sign the timber sale contract will prohibit you from bidding on future timber sales. If you are the successful bidder, you will be required to pay a performance bond of 15% of the total bid price at contract signing. You will also be required to provide copies of your SFI training and liability/workman's compensation certificates prior to signing the timber sale contract. **Contracts will not be issued without the 15% performance bond, SFI training certificate and liability/workman's compensation certificate.**

NOTICE: SFI and Insurance certificates must be maintained through the duration of the contract. At least one person working on the sale must be SFI Certified. Please note the payment method for each sale. Lump Sum sales require payment in full prior to starting the sale, or arrangements must be made with the seller to make block payments. Sales using the Mill Scale Ticket System will require the Purchaser to have load tickets sent directly from the receiving mill to the Seller within (10) days. Late load tickets will be invoiced by the Seller at 15 cords per load.

Please remember to complete and return the form on the last page of this handout to remain on Forest County's bid list. If you do not return this form, your name will be dropped from the list for 2015.

All Forest County timber sale maps, bid forms and bid results are also posted online by logging onto www.forestcountywi.com/forestry. Click on the "forestry" tab in the left menu then open "2014 Timber Sales".

Sincerely,

David W. Ziolkowski
County Forest Administrator

2014 Forest County Timber Sales

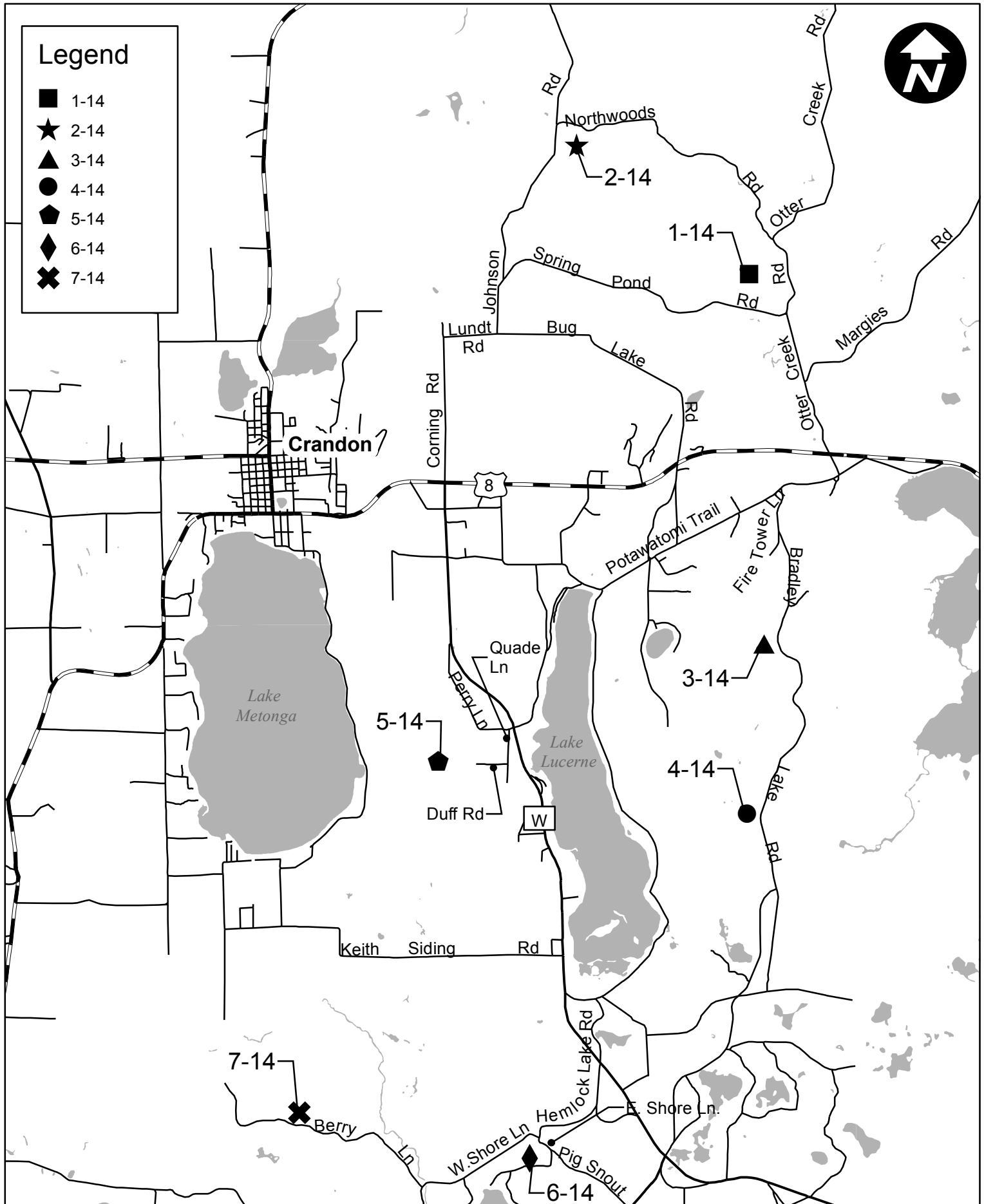

Forest County Forest
Oasis Timber Sale - Tract 1-14
 Parts of NENE, Sec. 23, NWNW, Sec. 24, SWSW Sec. 13, T.36N. R.13.E.
Sale area 47 acres
 (Mapped by Dan Peters 2/25/14)

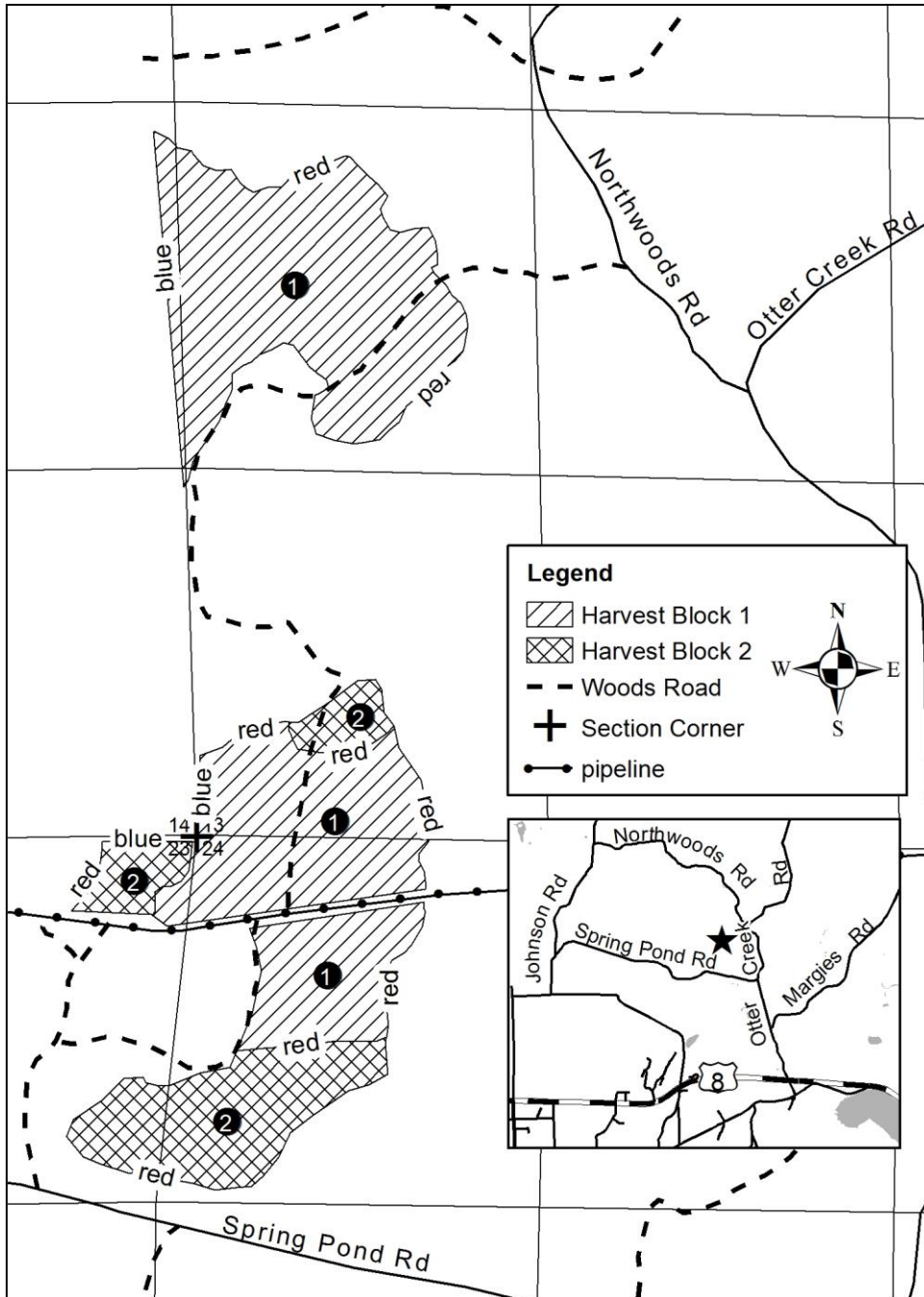

Harvest Specifications:

Block 1 (36 Acres)

- Cut all trees marked with orange paint. In addition, harvest all merchantable aspen, balsam fir, birch and ironwood.

Block 2 (11 Acres)

- Cut all trees 2 inches and larger, EXCEPT trees marked with green paint

All Blocks

- No cutting, skidding or trucking will be allowed during spring break up or wet soil conditions.
- No tree length or pole skidding is allowed without prior approval.
- All wood will be sorted by species and categories as listed in table below.
- Timber shall not be removed from premises unless it is field scaled by county staff.
- All species and products shall be cut concurrently.
- **Reasonable care shall be used to avoid unnecessary damage to residual trees and regeneration.**
- Do not cut dead trees unless marked with orange paint or, if they pose a safety hazard.
- No equipment use or slash disposal in wetlands or, in drainage by Northwoods Road.
- Any gates, rocks, berms or other barriers removed for access will be repaired or replaced.
- All slash and logging debris must be lopped to within 2 feet of the ground
- **Do not cut trees marked with green paint.**

Sale Information:

- Pulp & Bolts - Mill Ticket
- Saw Logs – Field Scale
- Other Products – Determined by County
- Completion Date: April 1, 2016
- Notify County in advance of starting
- Forestry Department: 715-478-3475

ESTIMATED VOLUME

Pulpwood / Bolts		Sawlogs	
Species	Cords	Species	BDFt
Mixed Hardwood Pulp and Bolts	310	Sugar Maple Logs	12,000
Basswood Pulp and Bolts	100	Basswood Logs	7,000
Aspen Pulp and Bolts	220	Mixed Hardwood Logs	2,000
Balsam Fir	35		
Total	665	Total	21,000

FOREST COUNTY FOREST TIMBER SALE BID SHEET

Oasis Sale - 1-14

Expires 4-1-2016	Mill ticket - pulp & bolts		All sawlogs field scaled	
Species/Product	Volume	Minimum bid	Bid/ Unit	Species Total
Mixed Hardwood Pulp & Bolts	310 cds			
Basswood Pulp & Bolts	100 cds			
Aspen Pulp & Bolts	220 cds			
Balsam Fir	35 cds			
Sugar Maple Sawlogs	12 Mbf			
Basswood Sawlogs	7 Mbf			
Mixed Harwood Sawlogs	2 Mbf			
TOTAL BID		\$21,434.00		

All products must have a bid price.

Bid sheets that are incomplete or have errors which make intent of bid unclear may be rejected. All products must have a bid price.

Bid bonds will be waived for 2014. If you are the successful bidder, you will be required to pay a performance bond of 15% of the total bid price at contract signing. You will also be required to provide copies of your SFI training and liability/workman's compensation certificates prior to signing the timber sale contract. At least one (1) person working on the sale must be SFI Certified. **Contracts will not be issued without the 15% performance bond, SFI training certificate and liability/workman's compensation certificate.**

The Seller has the right to reject any and all bids. Volumes are estimates. All bidders are encouraged to examine sale to verify volumes and quality of all timber. Bidders should be prepared to submit a performance bond and references upon request.

I hereby submit the above bid for the above described timber sale.

Bidders Name (Please print)

Address

City, State, Zip Code

Bidders signature

Date

Forest County Forest
Northwoods Washer Timber Sale - Tract 2-14
Parts of SE1/4, Sec. 10, T.36N. R.13.E.
Sale area 30 acres
(Mapped by Dan Peters 2/25/14)

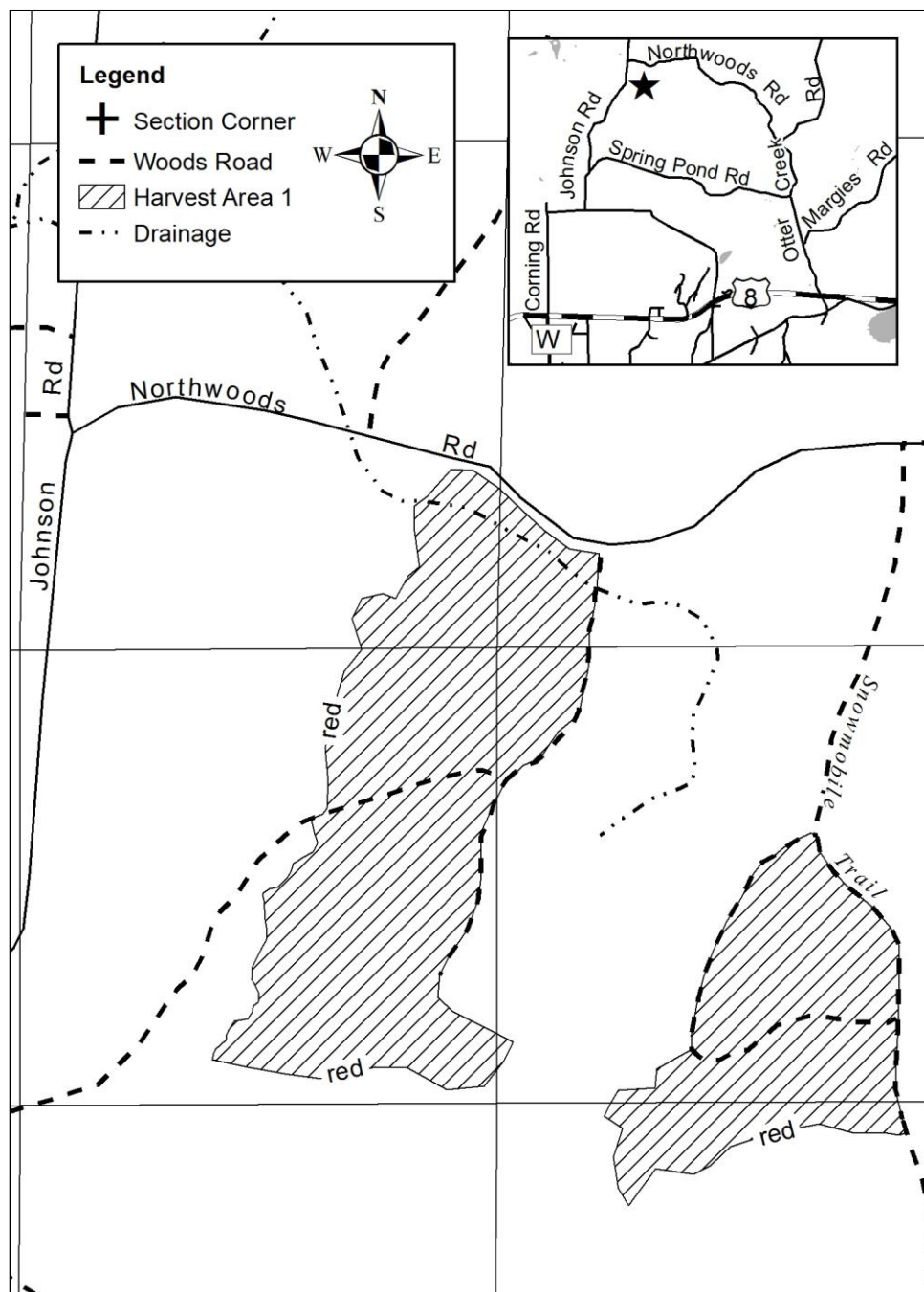

Harvest Specifications:

- Cut all trees marked with orange paint.
In addition, harvest all merchantable aspen, balsam fir, birch and ironwood.
- No cutting, skidding or trucking will be allowed during spring break up or wet soil conditions.
- No tree length or pole skidding is allowed without prior approval.
- All wood will be sorted by species and categories as listed in table below.
- All species and products shall be cut concurrently.
- **Reasonable care shall be used to avoid unnecessary damage to residual trees and regeneration.**
- Do not cut dead trees unless marked with orange paint or, if they pose a safety hazard.
- No equipment use or slash disposal in wetlands or, in drainage by Northwoods Road.
- Any gates, rocks, berms or other barriers removed for access will be repaired or replaced.
- All slash and logging debris must be lopped to within 2 feet of the ground
- **Do not cut trees marked with green paint.**

Sale Information:

- Pulp & Bolts - Mill Ticket
- Saw Logs – Field Scale
- Other Products – Determined by County
- Completion Date: April 1, 2016
- Notify County in advance of starting
- Forestry Department: 715-478-3475

ESTIMATED VOLUME

Pulpwood / Bolts		Sawlogs	
Species	Cords	Species	BDFT
Mixed Hardwood Pulp and Bolts	175	Sugar Maple Logs	3,500
Basswood Pulp and Bolts	45	Basswood Logs	5,500
		Mixed Hardwood Logs	1,000
Total	220	Total	10,000

FOREST COUNTY FOREST TIMBER SALE BID SHEET

Northwoods Washer Sale - 2-14

Expires 4-1-2016	Mill ticket - pulp & bolts		All sawlogs field scaled	
Species/Product	Volume	Minimum bid	Bid/ Unit	Species Total
Mixed Hardwood Pulp & Bolts	175 cds			
Basswood Pulp & Bolts	45 cds			
Sugar Maple Sawlogs	3.5 MBF			
Basswood Sawlogs	5.5 MBF			
Mixed Harwood Sawlogs	1.0 MBF			
TOTAL BID		\$8,085.00		

All products must have a bid price.

Bid sheets that are incomplete or have errors which make intent of bid unclear may be rejected. All products must have a bid price.

Bid bonds will be waived for 2014. If you are the successful bidder, you will be required to pay a performance bond of 15% of the total bid price at contract signing. You will also be required to provide copies of your SFI training and liability/workman's compensation certificates prior to signing the timber sale contract. At least one (1) person working on the sale must be SFI Certified. **Contracts will not be issued without the 15% performance bond, SFI training certificate and liability/workman's compensation certificate.**

The Seller has the right to reject any and all bids. Volumes are estimates. All bidders are encouraged to examine sale to verify volumes and quality of all timber. Bidders should be prepared to submit a performance bond and references upon request.

I hereby submit the above bid for the above described timber sale.

Bidders Name (Please print)

Address

City, State, Zip Code

Bidders signature

Date

Forest County Forest
Kringle Timber Sale - Tract 3-14
 NENW, SWNW, SENW, Sec. 1, T.35N. R.13.E.
Sale area 24 acres
 (Mapped by Dan Peters 2/25/14)

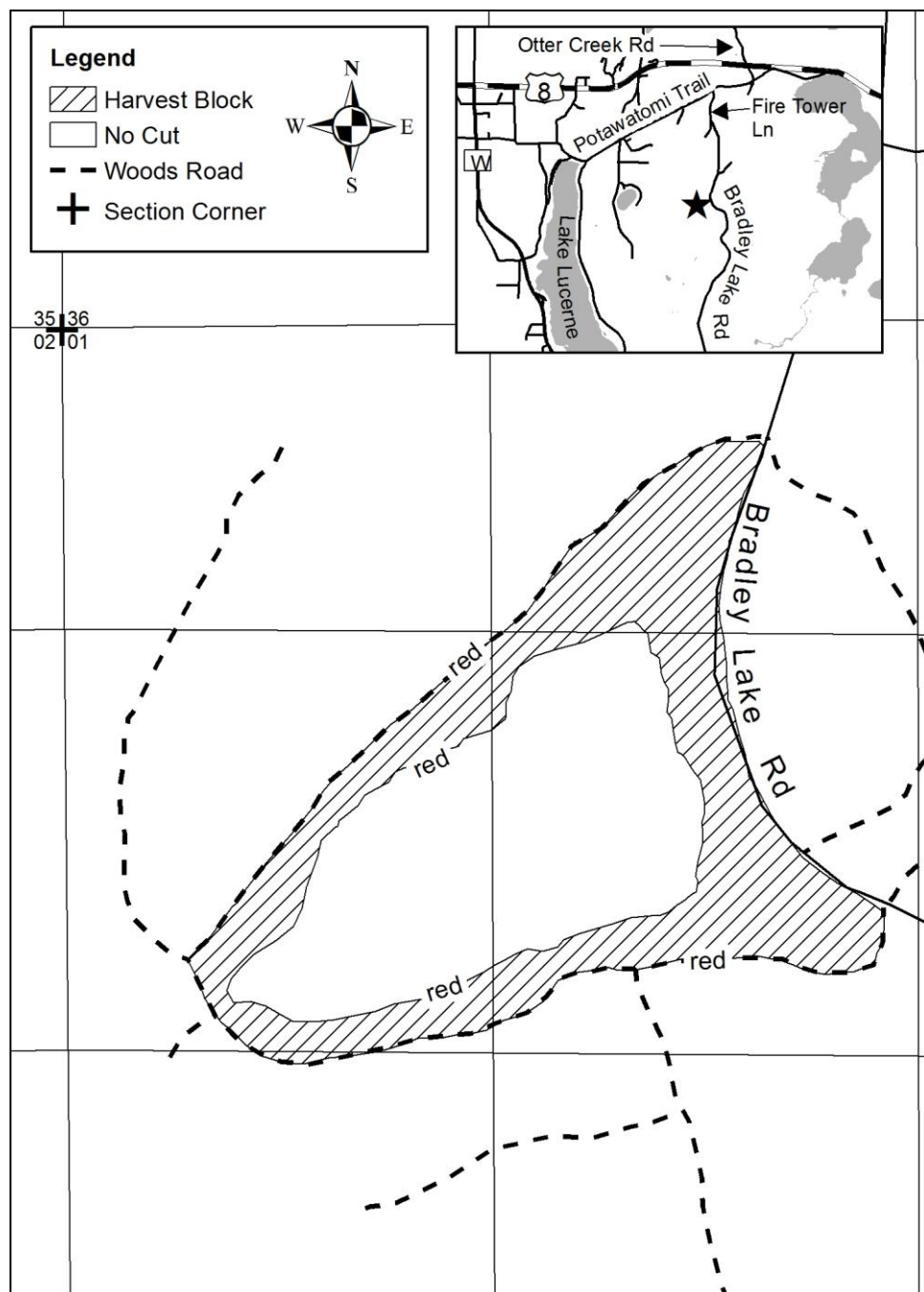

Harvest Specifications:

- Cut all trees 2 inches and larger, **EXCEPT red oak, white pine, cedar, hemlock and trees marked with green paint.**
- No cutting, skidding or trucking will be allowed during spring break up or wet soil conditions.
- No tree length or pole skidding is allowed without prior approval.
- All wood will be sorted by species and categories as listed in table below.
- All species and products shall be cut concurrently.
- Reasonable care shall be used to avoid unnecessary damage to reserve trees.
- **Do not cut dead trees unless marked with orange paint or, if they pose a safety hazard.**
- No equipment use or slash disposal in wetlands.
- Any gates, rocks, berms or other barriers removed for access will be repaired or replaced.
- All slash and logging debris must be lopped to within 2 feet of the ground.

Sale Information:

- Pulp & Bolts - Mill Ticket
- Saw Logs – Field Scale
- Other Products – Determined by County
- Completion Date: April 1, 2016
- Notify County in advance of starting
- Forestry Department: 715-478-3475

ESTIMATED VOLUME

Pulpwood / Bolts		Sawlogs	
Species	Cords	Species	BDFT
Aspen Pulp and Bolts	770		
Mixed Hardwood Pulp and Bolts	30		
Balsam Fir	20		
Spruce	10		
Total	830	Total	

FOREST COUNTY FOREST TIMBER SALE BID SHEET

Kringle Sale - 3-14

Expires 4-1-2016	Mill ticket - pulp & bolts		All sawlogs field scaled	
Species/Product	Volume	Minimum bid	Bid/ Unit	Species Total
Aspen Pulp & Bolts	770			
Mixed Hardwood Pulp & Bolts	30			
Balsam Fir	20			
Spruce	10			
TOTAL BID		\$24,453.00		

All products must have a bid price.

Bid sheets that are incomplete or have errors which make intent of bid unclear may be rejected. All products must have a bid price.

Bid bonds will be waived for 2014. If you are the successful bidder, you will be required to pay a performance bond of 15% of the total bid price at contract signing. You will also be required to provide copies of your SFI training and liability/workman's compensation certificates prior to signing the timber sale contract. At least one (1) person working on the sale must be SFI Certified. **Contracts will not be issued without the 15% performance bond, SFI training certificate and liability/workman's compensation certificate.**

The Seller has the right to reject any and all bids. Volumes are estimates. All bidders are encouraged to examine sale to verify volumes and quality of all timber. Bidders should be prepared to submit a performance bond and references upon request.

I hereby submit the above bid for the above described timber sale.

Bidders Name (Please print)

Address

City, State, Zip Code

Bidders signature

Date

Forest County Forest
Last One Timber Sale - Tract 4-14
Parts of the S1/2 SE1/4, Sec.11, SWSW, Sec. 12, T.35N. R.13.E.
Sale area 27 acres
(Mapped by Dan Peters 2/25/14)

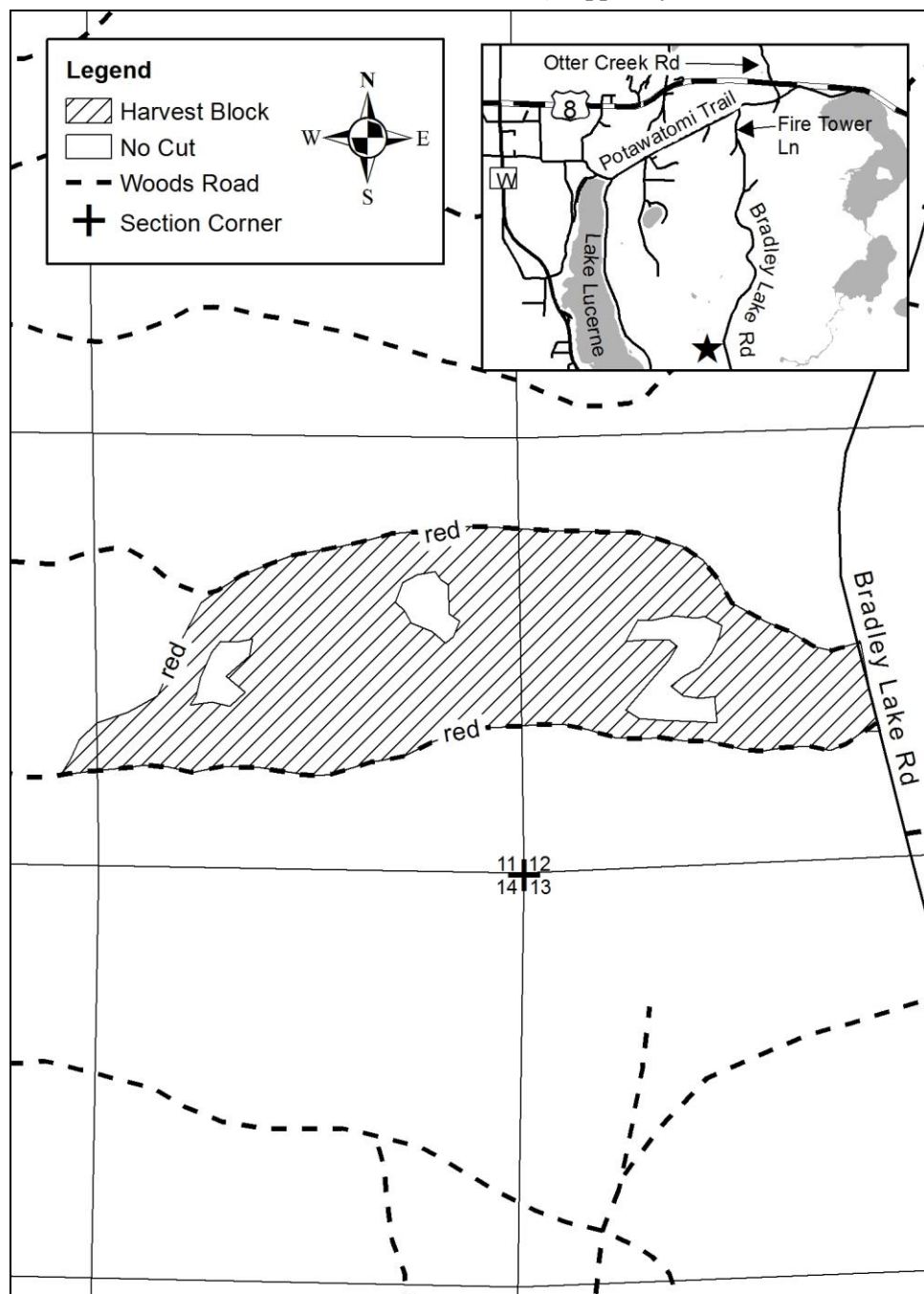

Harvest Specifications:

- Cut all trees 2 inches and larger, **EXCEPT red oak, white pine, cedar, hemlock and trees marked with green paint.**
- No cutting, skidding or trucking will be allowed during spring break up or wet soil conditions.
- No tree length or pole skidding is allowed without prior approval.
- All wood will be sorted by species and categories as listed in table below.
- All species and products shall be cut concurrently.
- Reasonable care shall be used to avoid unnecessary damage to reserve trees.
- **Do not cut dead trees unless marked with orange paint or, if they pose a safety hazard.**
- No equipment use or slash disposal in wetlands.
- Any gates, rocks, berms or other barriers removed for access will be repaired or replaced.
- All slash and logging debris must be lopped to within 2 feet of the ground.

Sale Information:

- Pulp & Bolts - Mill Ticket
- Saw Logs – Field Scale
- Other Products – Determined by County
- Completion Date: April 1, 2016
- Notify County in advance of starting
- Forestry Department: 715-478-3475

ESTIMATED VOLUME

Pulpwood / Bolts		Sawlogs	
Species	Cords	Species	BDFt
Aspen Pulp and Bolts	765	Mixed Hardwood Logs	2,000
Mixed Hardwood Pulp and Bolts	80		
Balsam Fir	5		
Total	850	Total	2,000

FOREST COUNTY FOREST TIMBER SALE BID SHEET

Last One Sale - 4-14

Expires 4-1-2016	Mill ticket - pulp & bolts		All sawlogs field scaled	
Species/Product	Volume	Minimum bid	Bid/ Unit	Species Total
Aspen Pulp & Bolts	765 cds			
Mixed Hardwood Pulp & Bolts	80 cds			
Balsam Fir	5cds			
Mixed Harwood Sawlogs	2.0 MBF			
TOTAL BID		\$25,042.50		

All products must have a bid price.

Bid sheets that are incomplete or have errors which make intent of bid unclear may be rejected. All products must have a bid price.

Bid bonds will be waived for 2014. If you are the successful bidder, you will be required to pay a performance bond of 15% of the total bid price at contract signing. You will also be required to provide copies of your SFI training and liability/workman's compensation certificates prior to signing the timber sale contract. At least one (1) person working on the sale must be SFI Certified. **Contracts will not be issued without the 15% performance bond, SFI training certificate and liability/workman's compensation certificate.**

The Seller has the right to reject any and all bids. Volumes are estimates. All bidders are encouraged to examine sale to verify volumes and quality of all timber. Bidders should be prepared to submit a performance bond and references upon request.

I hereby submit the above bid for the above described timber sale.

Bidders Name (Please print)

Address

City, State, Zip Code

Bidders signature

Date

Forest County Forest
AA Timber Sale - Tract 5-14
Parts of NW1/4, NWNE, SWNE Sec. 9, T.35N. R.13.E.
Sale area 26 acres
(Mapped by Dan Peters 2/25/14)

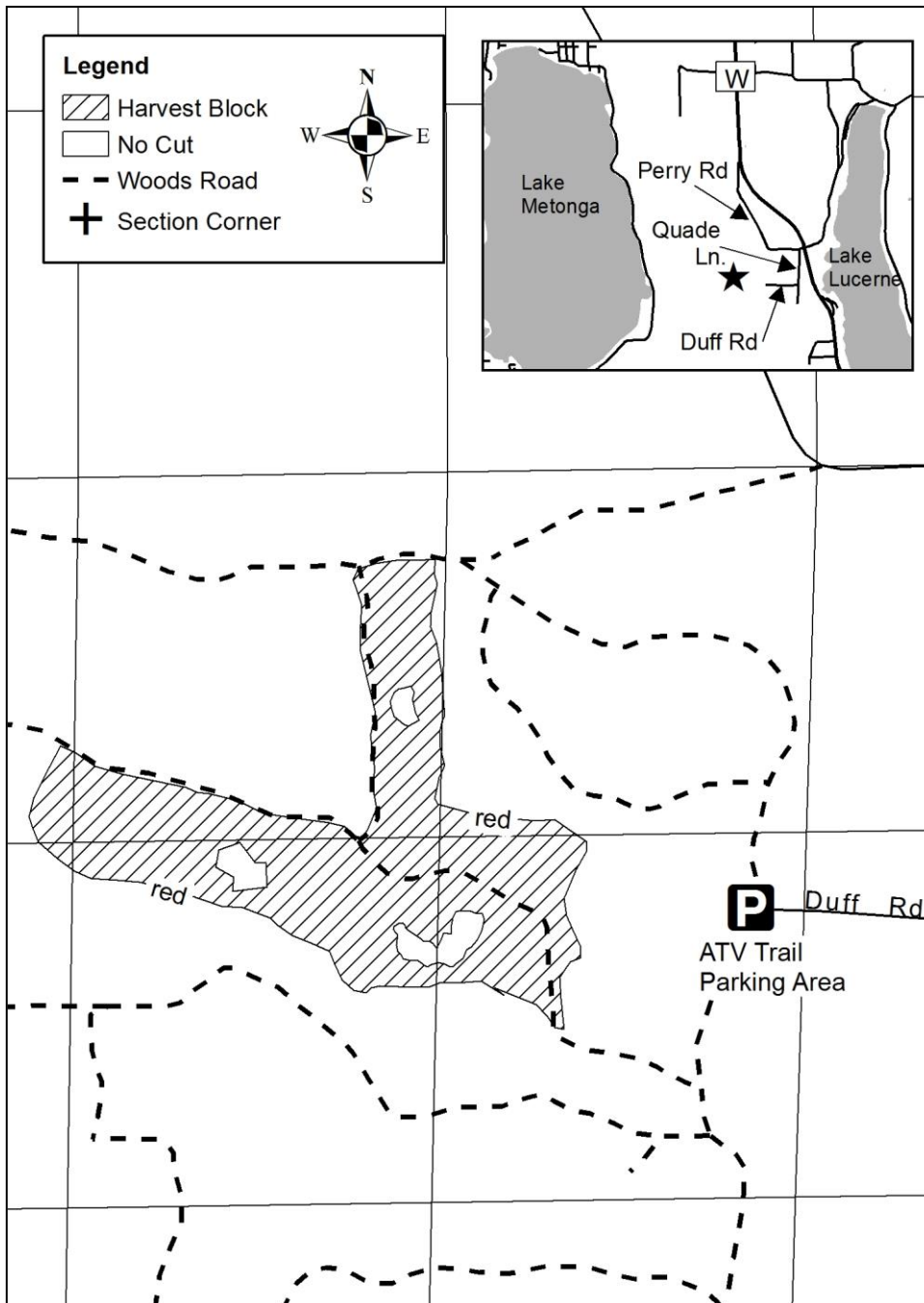

Harvest Specifications:

- Cut all trees 2 inches and larger, **EXCEPT trees marked with green paint**
- No cutting, skidding or trucking will be allowed during spring break up or wet soil conditions.
- No tree length or pole skidding is allowed without prior approval.
- All wood will be sorted by species and categories as listed in table below.
- All species and products shall be cut concurrently.
- Reasonable care shall be used to avoid unnecessary damage to reserve trees.
- **Do not cut dead trees unless marked with orange paint or, if they pose a safety hazard.**
- No equipment use or slash disposal in wetlands.
- Any gates, rocks, berms or other barriers removed for access will be repaired or replaced.
- All slash and logging debris must be lopped to within 2 feet of the ground and pulled back 25 feet from road.

Sale Information:

- Pulp & Bolts - Mill Ticket
- Saw Logs – Field Scale
- Other Products – Determined by County
- Completion Date: April 1, 2016
- Notify County in advance of starting
- Forestry Department: 715-478-3475

ESTIMATED VOLUME

Pulpwood / Bolts		Sawlogs	
Species	Cords	Species	BDFT
Aspen Pulp and Bolts	560	Basswood Logs	6,000
Mixed Hardwood Pulp and Bolts	120	Mixed Hardwood Logs	4,000
Basswood Pulp & Bolts	35		
Total	715	Total	10,000

FOREST COUNTY FOREST TIMBER SALE BID SHEET

AA Sale - 5-14

Expires 4-1-2016	Mill ticket - pulp & bolts		All sawlogs field scaled	
Species/Product	Volume	Minimum bid	Bid/ Unit	Species Total
Aspen Pulp & Bolts	560 cds			
Mixed Hardwood Pulp & Bolts	120 cds			
Basswood Pulp & Bolts	35 cds			
Basswood Sawlogs	6 Mbf			
Mixed Harwood Sawlogs	4 Mbf			
TOTAL BID		\$21,799.50		

All products must have a bid price.

Bid sheets that are incomplete or have errors which make intent of bid unclear may be rejected. All products must have a bid price.

Bid bonds will be waived for 2014. If you are the successful bidder, you will be required to pay a performance bond of 15% of the total bid price at contract signing. You will also be required to provide copies of your SFI training and liability/workman's compensation certificates prior to signing the timber sale contract. At least one (1) person working on the sale must be SFI Certified. **Contracts will not be issued without the 15% performance bond, SFI training certificate and liability/workman's compensation certificate.**

The Seller has the right to reject any and all bids. Volumes are estimates. All bidders are encouraged to examine sale to verify volumes and quality of all timber. Bidders should be prepared to submit a performance bond and references upon request.

I hereby submit the above bid for the above described timber sale.

Bidders Name (Please print)

Address

City, State, Zip Code

Bidders signature

Date

Forest County Forest
Uno Mas Timber Sale - Tract 6-14
Parts of SW1/4, Sec. 27, T.35N. R.13.E.
Sale area 52 acres
(Mapped by Dan Peters 2/25/14)

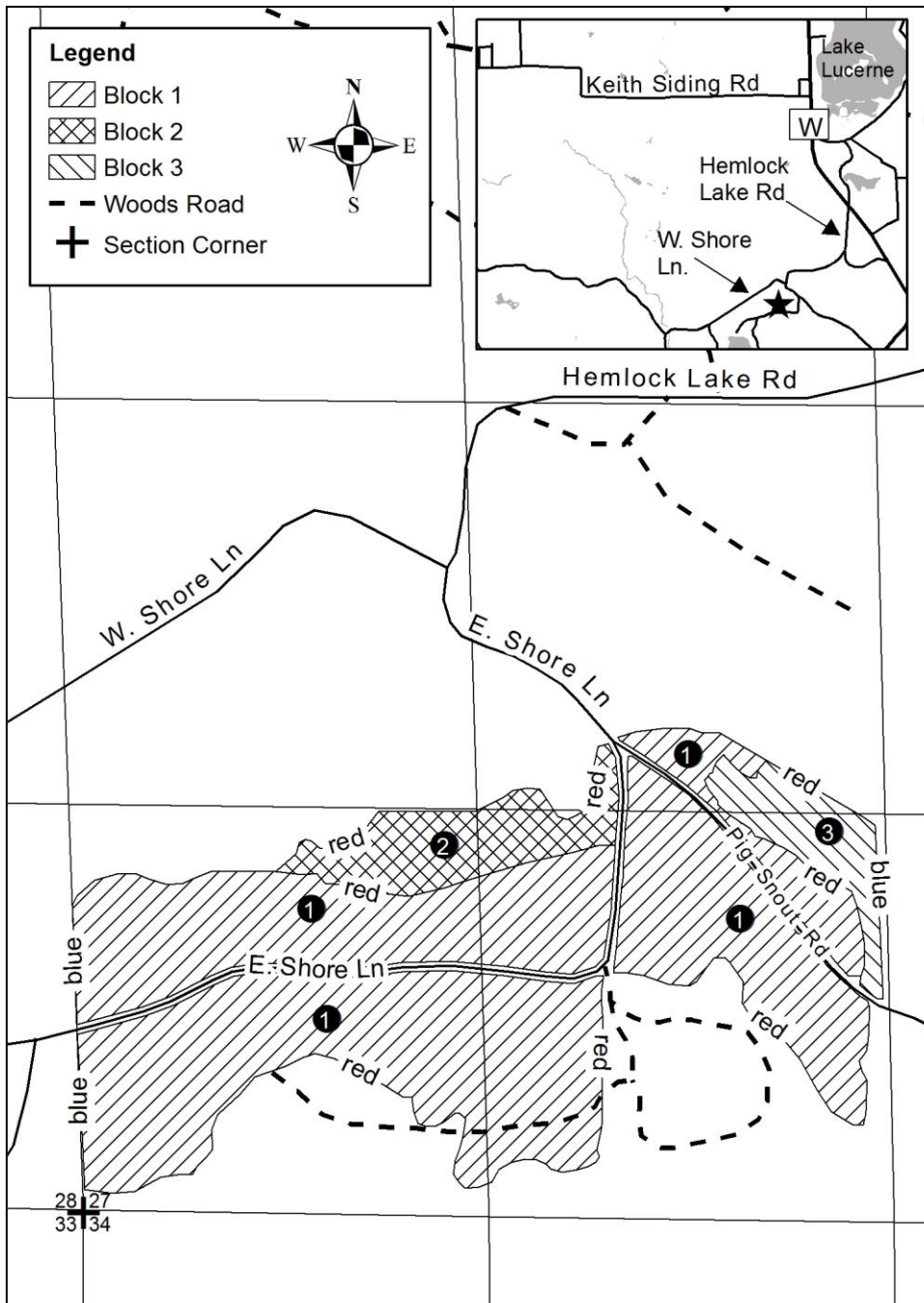

Harvest Specifications:

Block 1

- Cut all trees marked with orange paint.
In addition, harvest all merchantable aspen, balsam fir, birch and ironwood.

Blocks 2 (Spruce) & 3 (Aspen)

- Cut all trees 2 inches and larger **except trees marked with green paint.**

All Blocks

- No cutting, skidding or trucking will be allowed during spring break up or wet soil conditions.
- No tree length or pole skidding is allowed without prior approval.
- All wood will be sorted by species and categories as listed in table below.
- All species and products shall be cut concurrently.
- **Reasonable care shall be used to avoid unnecessary damage to residual trees and regeneration.**
- Do not cut dead trees unless marked with orange paint or, if they pose a safety hazard.
- No equipment use or slash disposal in wetlands.
- Any gates, rocks, berms or other barriers removed for access will be repaired or replaced.
- All slash and logging debris must be lopped to within 2 feet of the ground

Sale Information:

- Pulp & Bolts - Mill Ticket
- Saw Logs - Field Scale
- Other Products - Determined by County
- If cut between March 15 and December 1, pine and spruce stumps must be treated with Sporax or other antifungal treatment approved for prevention of annosum root rot.
- Completion Date: April 1, 2016
- Notify County in advance of starting
- Forestry Department: 715-478-3475

ESTIMATED VOLUME

Pulpwood / Bolts		Sawlogs	
Species	Cords	Species	BDFt
Red Pine	375	Sugar Maple Logs	2,500
Spruce	300	Mixed Hardwood Logs	1,000
Aspen Pulp & Bolts	60		
Mixed Hardwood Pulp & Bolts	45		
Balsam Fir	5		
Total	785	Total	3,500

FOREST COUNTY FOREST TIMBER SALE BID SHEET

Uno mas Sale - 6-14

Expires 4-1-2016	Mill ticket - pulp & bolts		All sawlogs field scaled	
Species/Product	Volume	Minimum bid	Bid/ Unit	Species Total
Red Pine	375 cds			
Spruce	300 cds			
Aspen Pulp & Bolts	60 cds			
Mixed Hardwood Pulp & Bolts	45 cds			
Balsam Fir	5 cds			
Sugar Maple Sawlogs	2.5 Mbf			
Mixed Harwood Sawlogs	1.0 Mbf			
TOTAL BID		\$33,661.50		

All products must have a bid price.

Bid sheets that are incomplete or have errors which make intent of bid unclear may be rejected. All products must have a bid price.

Bid bonds will be waived for 2014. If you are the successful bidder, you will be required to pay a performance bond of 15% of the total bid price at contract signing. You will also be required to provide copies of your SFI training and liability/workman's compensation certificates prior to signing the timber sale contract. At least one (1) person working on the sale must be SFI Certified. **Contracts will not be issued without the 15% performance bond, SFI training certificate and liability/workman's compensation certificate.**

The Seller has the right to reject any and all bids. Volumes are estimates. All bidders are encouraged to examine sale to verify volumes and quality of all timber. Bidders should be prepared to submit a performance bond and references upon request.

I hereby submit the above bid for the above described timber sale.

Bidders Name (Please print)

Address

City, State, Zip Code

Bidders signature

Date

Forest County Forest
Chewbacca Timber Sale – Tract 7-14
Parts of NE1/4, NENE Sec. 29, T.35N. R.13.E.
Sale area 103 acres
(Mapped by Dan Peters 2/25/14)

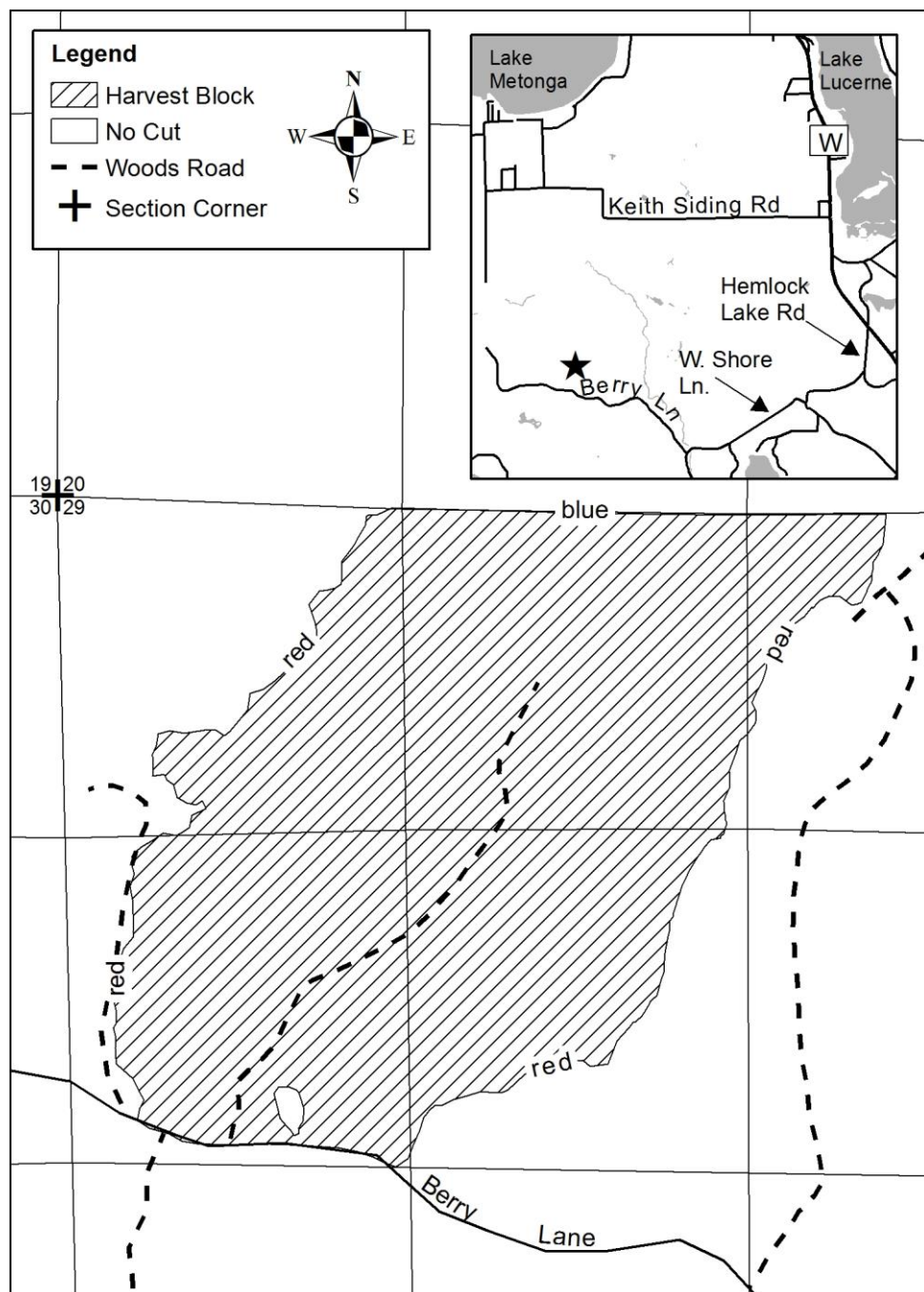

Harvest Specifications:

- Cut all trees marked with orange paint. **In addition, harvest all merchantable aspen, balsam fir, birch and ironwood.**
- No cutting, skidding or trucking will be allowed during spring break up or wet soil conditions.
- No tree length or pole skidding is allowed without prior approval.
- All wood will be sorted by species and categories as listed in table below.
- All species and products shall be cut concurrently.
- **Reasonable care shall be used to avoid unnecessary damage to residual trees and regeneration.**
- Do not cut dead trees unless marked with orange paint or, if they pose a safety hazard.
- No equipment use or slash disposal in wetlands.
- Any gates, rocks, berms or other barriers removed for access will be repaired or replaced.
- All slash and logging debris must be lopped to within 2 feet of the ground
- **Do not cut trees marked with green paint.**

Sale Information:

- Pulp & Bolts - Mill Ticket
- Saw Logs – Field Scale
- Other Products – Determined by County
- Completion Date: April 1, 2016
- Notify County in advance of starting
- Forestry Department: 715-478-3475

ESTIMATED VOLUME

Pulpwood / Bolts		Sawlogs	
Species	Cords	Species	BDFt
Mixed Hardwood Pulp and Bolts	470	Sugar Maple Logs	23,500
Basswood Pulp and Bolts	285	Basswood Logs	17,000
Aspen Pulp and Bolts	5	Mixed Hardwood Logs	4,500
Total	760	Total	45,000

FOREST COUNTY FOREST TIMBER SALE BID SHEET

Chewbacca Sale - 7-14

Expires 4-1-2016	Mill ticket - pulp & bolts		All sawlogs field scaled	
Species/Product	Volume	Minimum bid	Bid/ Unit	Species Total
Mixed Hardwood Pulp & Bolts	470 cds			
Basswood Pulp & Bolts	285 cds			
Aspen Pulp & Bolts	5 cds			
Sugar Maple Sawlogs	23.5 Mbf			
Basswood Sawlogs	17 Mbf			
Mixed Harwood Sawlogs	4.5 Mbf			
TOTAL BID		\$28,987.00		

All products must have a bid price.

Bid sheets that are incomplete or have errors which make intent of bid unclear may be rejected. All products must have a bid price.

Bid bonds will be waived for 2014. If you are the successful bidder, you will be required to pay a performance bond of 15% of the total bid price at contract signing. You will also be required to provide copies of your SFI training and liability/workman's compensation certificates prior to signing the timber sale contract. At least one (1) person working on the sale must be SFI Certified. **Contracts will not be issued without the 15% performance bond, SFI training certificate and liability/workman's compensation certificate.**

The Seller has the right to reject any and all bids. Volumes are estimates. All bidders are encouraged to examine sale to verify volumes and quality of all timber. Bidders should be prepared to submit a performance bond and references upon request.

I hereby submit the above bid for the above described timber sale.

Bidders Name (Please print)

Address

City, State, Zip Code

Bidders signature

Date

TO: Prospective Bidders of Forest County Timber Sales

DATE: March 19, 2014

If you would like your name to remain on the bidder list for future Forest County Timber Sales, please complete the information below and return it to this office at:

**Forest County Forestry Department
Attn: David Ziolkowski, Administrator
200 E. Madison St.
Crandon, Wisconsin 54520**

If this letter is not returned by May 1, 2014 we will assume you no longer wish to be included as a potential bidder and will remove your name from our mailing list.

Name _____

Address _____

Email Address _____

**If you would like to have the Timber Sale bid packet emailed to you in the future, please provide your email address.*

Please indicate your preference for timber sale bid opening. Would you like to have the sales advertised by gun deer season (fall) or before/during spring break-up (spring)?

___ Fall Timber Sales

___ Spring Timber Sale